



Hahn KT-Rollenband NL

- D** Rollenband für Blockprofile
- NL** Rollenband voor blokprofielen
- GB** Butt hinge for block sections



Einbauanleitung · Montage-instructies · *Installation instructions*



Einbauanleitung Inbouwhandleiding Installation instructions

Einzelteile · Onderdelen · Single Parts

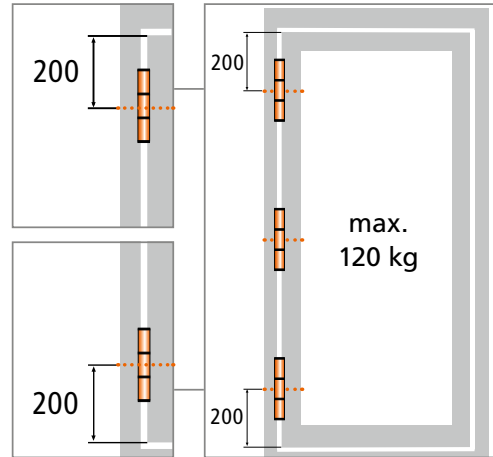

Wartungsfreie Lagerbuchse
– keinesfalls schmieren!

Lagerbussen onderhoudsvrij
– in geen geval smeren!

Bearing bushes maintenance-free
– do not lubricate!

Montage des Türbands · Montage van het scharnier · Installing the hinge

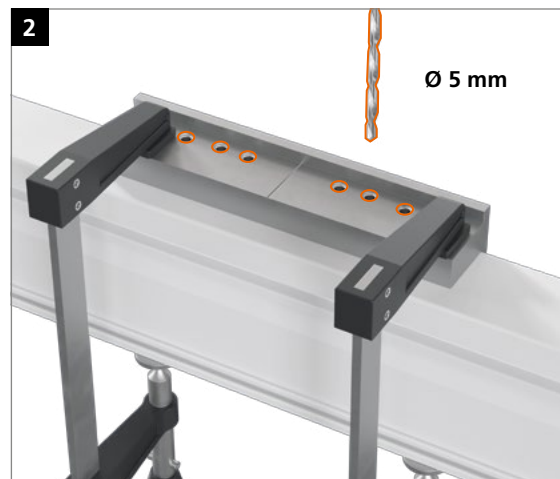
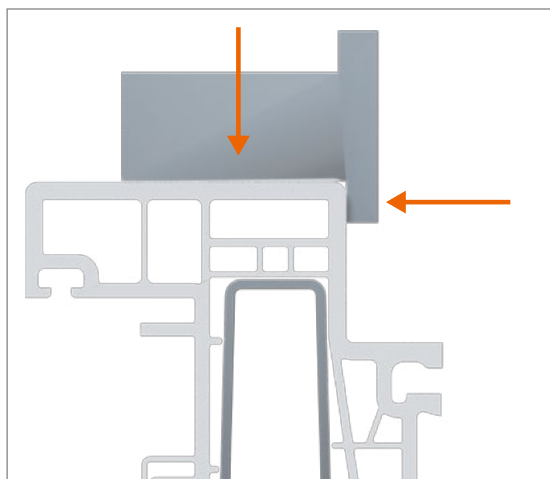
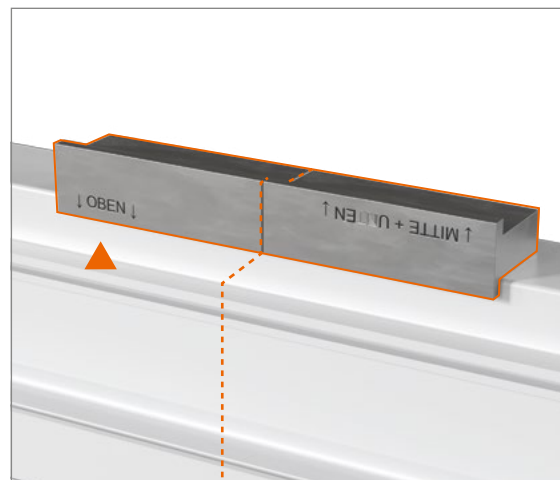
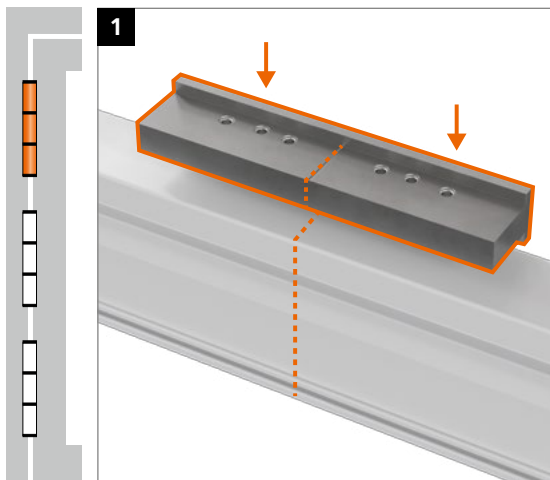

Einbauanleitung
Inbouwhandleiding
Installation instructions

Montage des Türbands · Montage van het scharnier · Installing the hinge

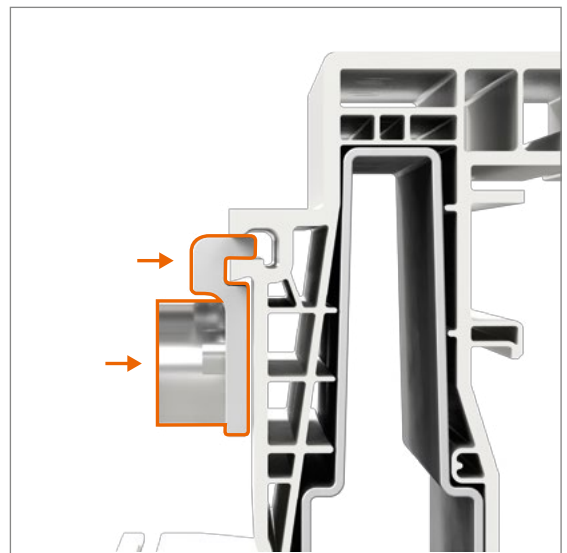
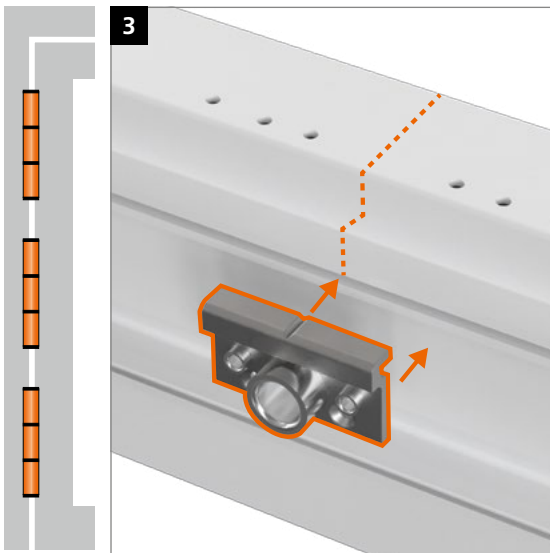
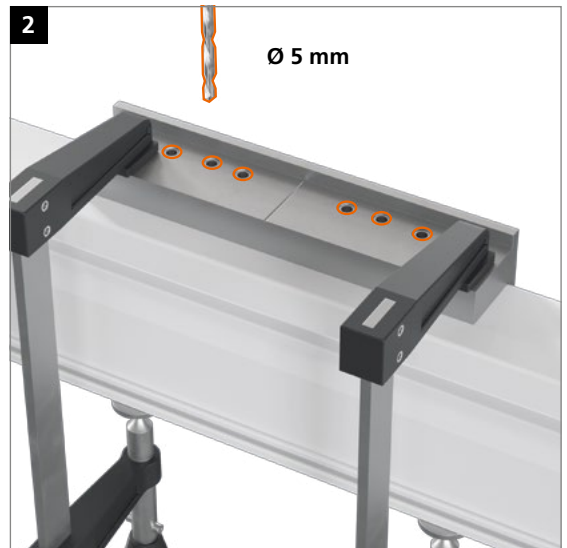
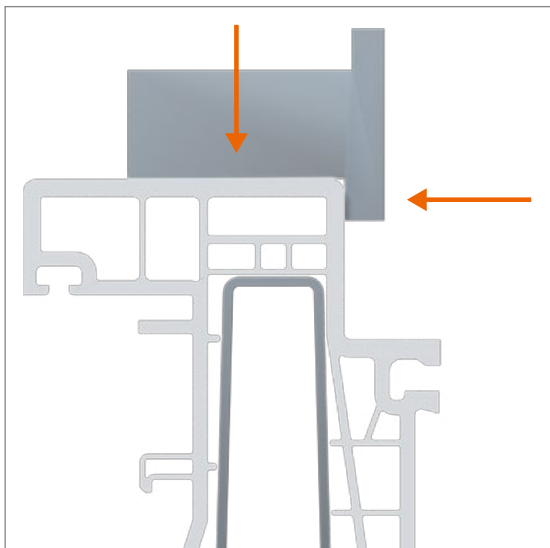
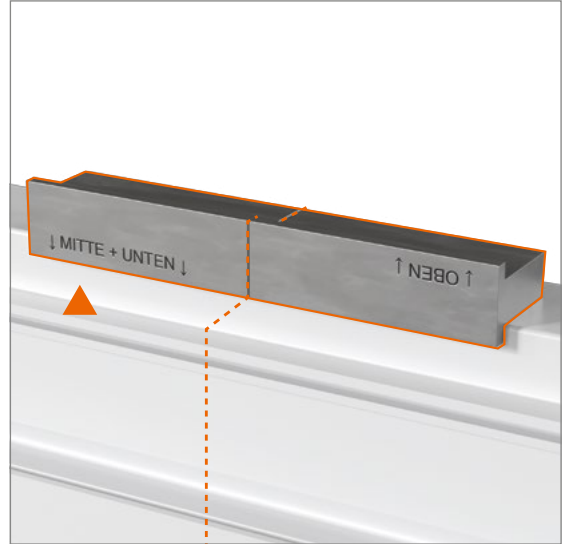
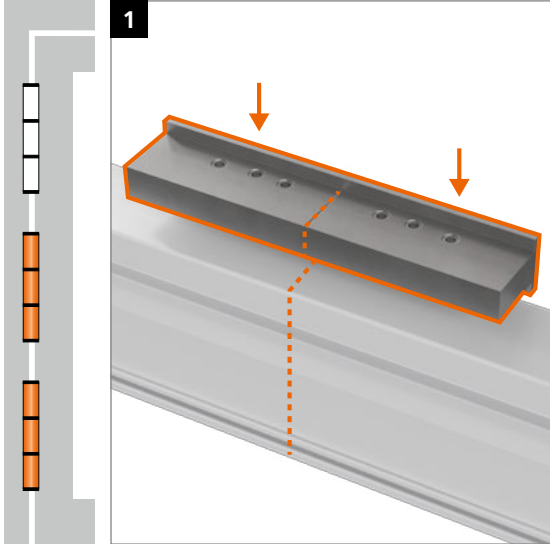

Einbauanleitung
Inbouwhandleiding
Installation instructions

Montage des Türbands · Montage van het scharnier · Installing the hinge

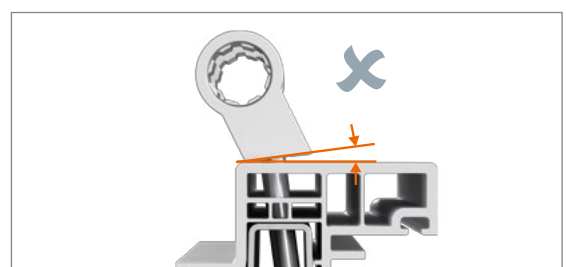
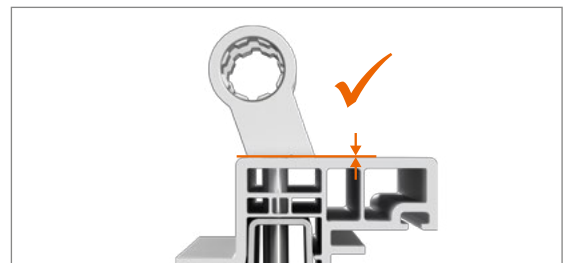
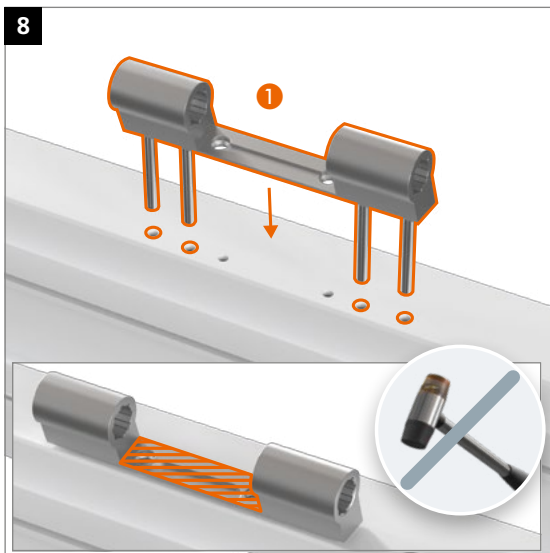
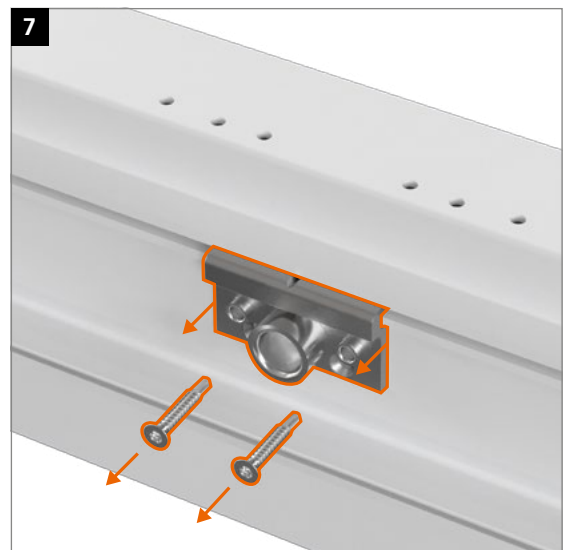
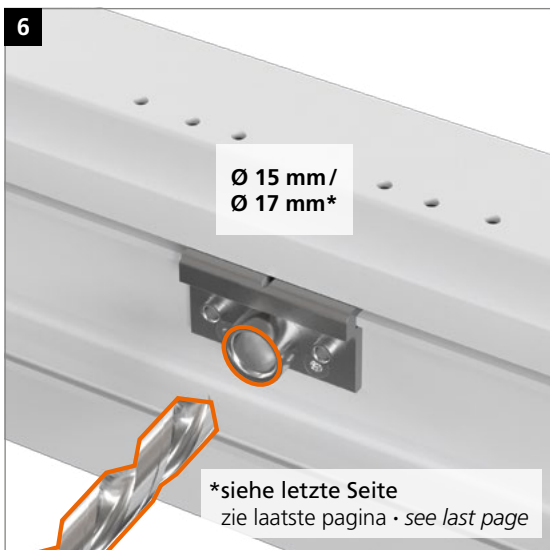
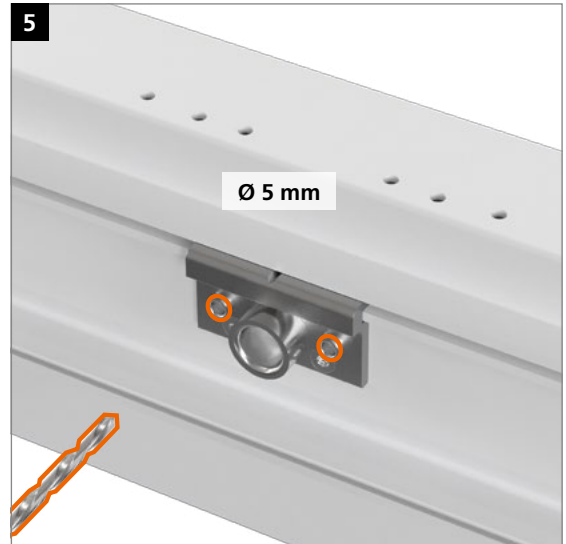
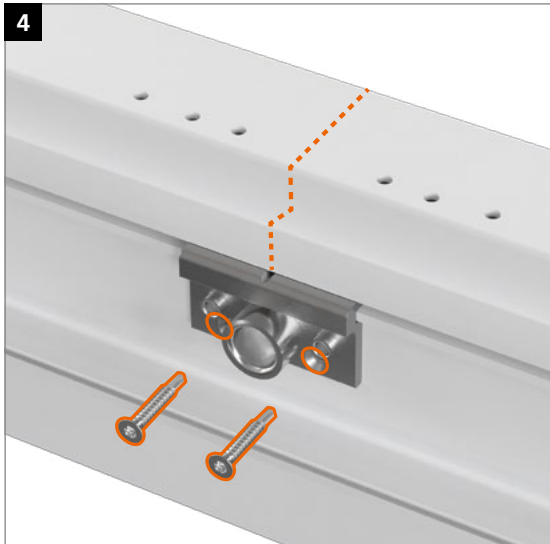

Einbauanleitung
Inbouwhandleiding
Installation instructions

Montage des Türbands · Montage van het scharnier · Installing the hinge

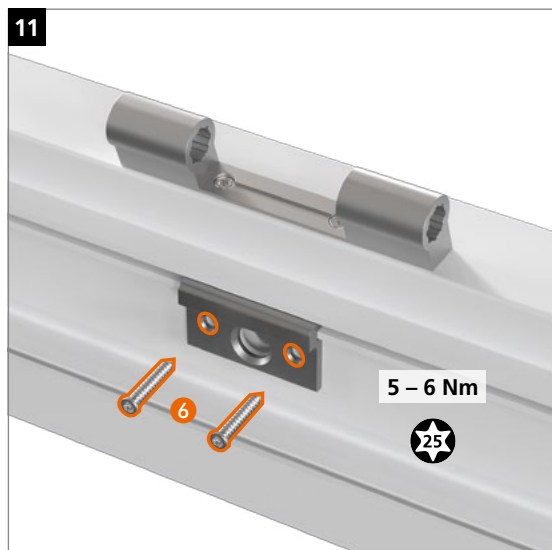
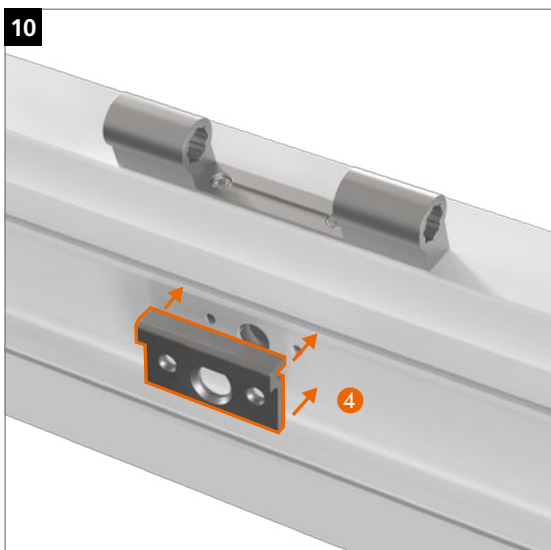
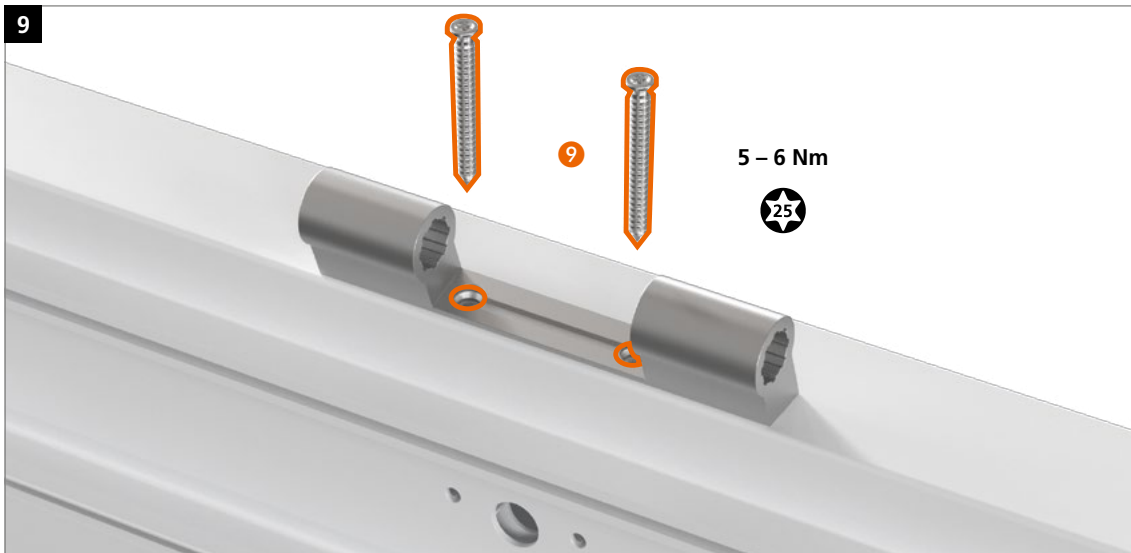

Einbauanleitung

Inbouwhandleiding

Installation instructions

Montage des Türbands · Montage van het scharnier · Installing the hinge



Markierungen am Buchsenkragen zeigen oben und unten:

Peiltjes op de rand van de lagerbus wijzen boven of onder aan:

The markings on the collar on the upper and bottom hinge point:

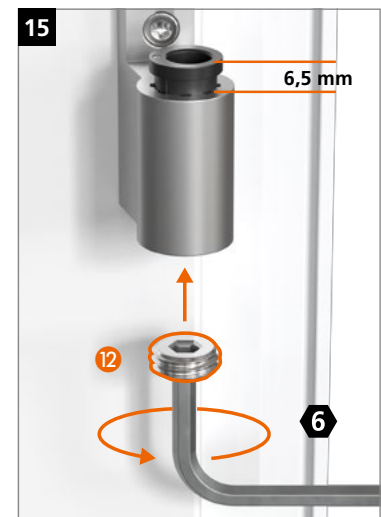
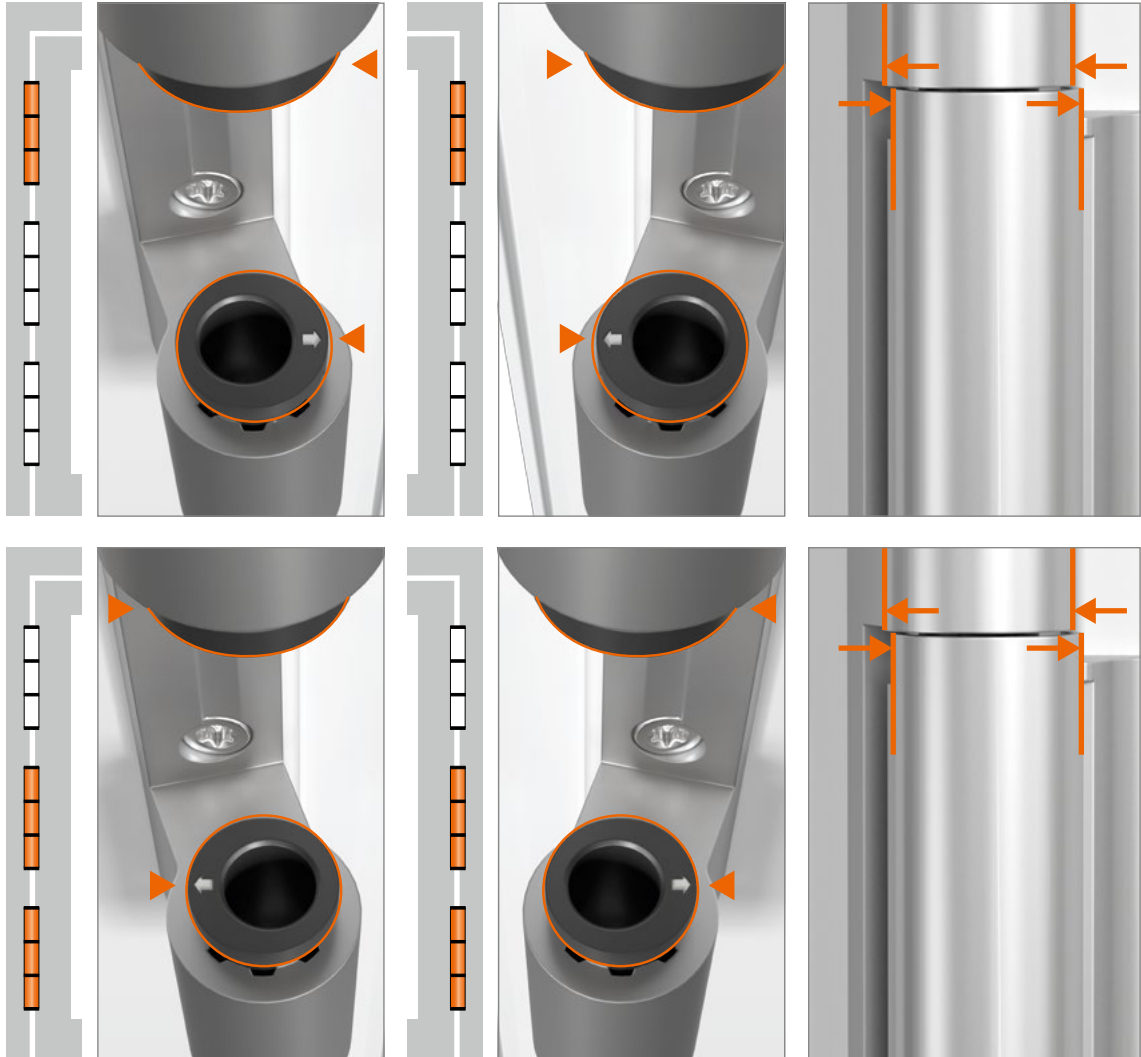

Einbauanleitung
Inbouwhandleiding
Installation instructions

Montage des Türbands · Montage van het scharnier · Installing the hinge

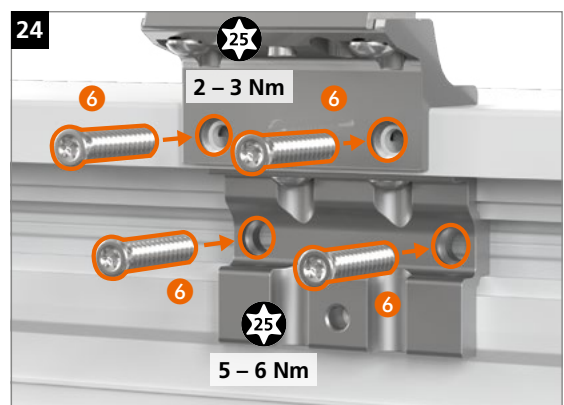
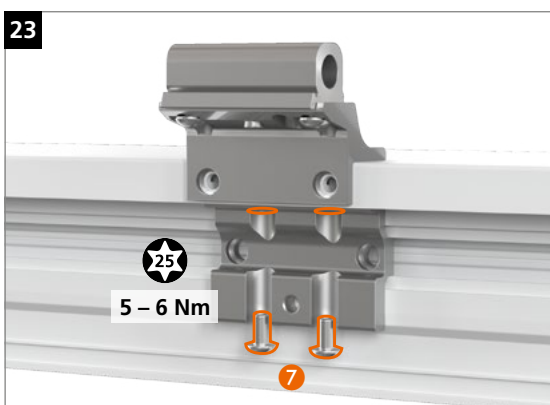
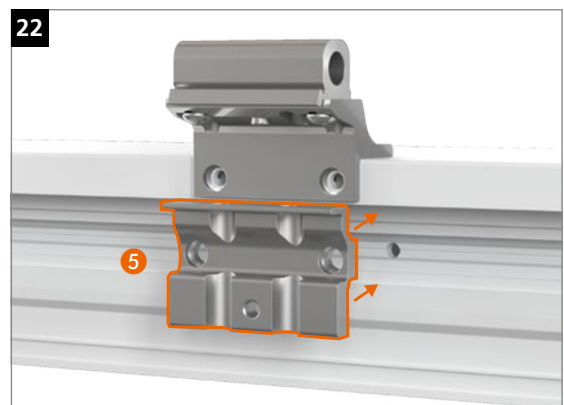
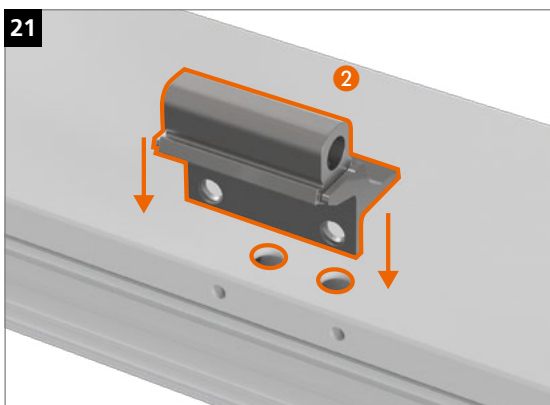
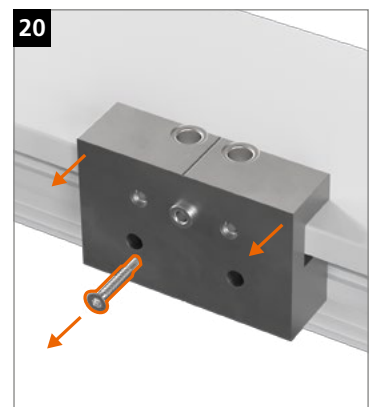
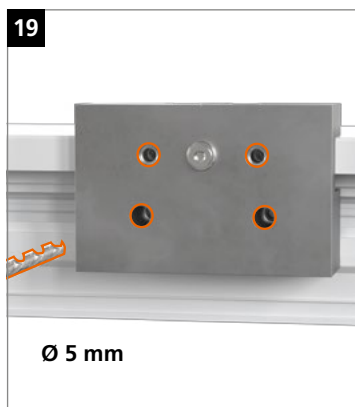
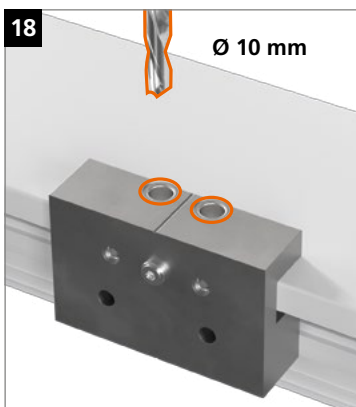
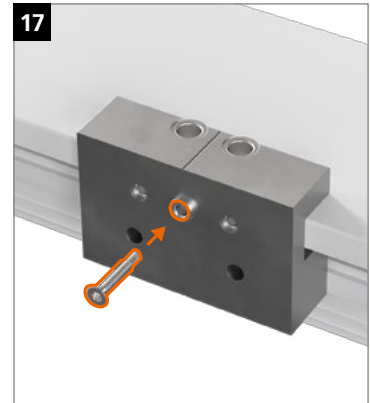
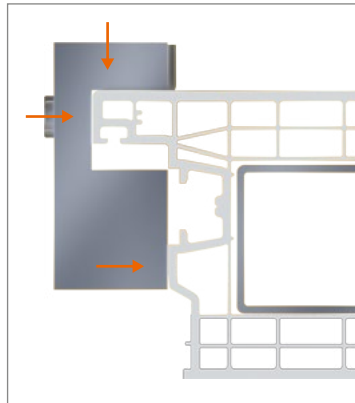
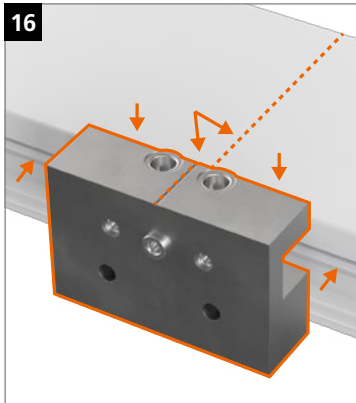

Einbauanleitung
Inbouwhandleiding
Installation instructions

Montage des Türbands · Montage van het scharnier · Installing the hinge

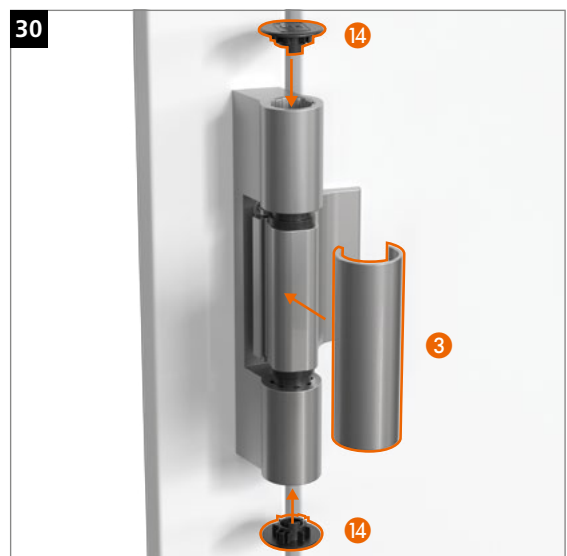
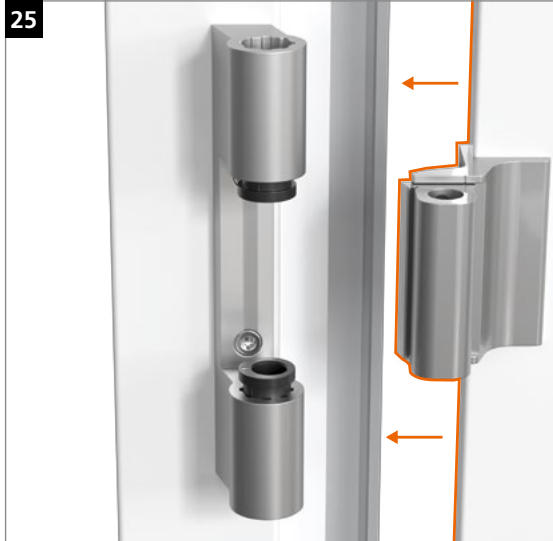

Einstellanleitung

Verstelhandleiding

Adjustment instructions

Verstellung der Bänder nur durch im Türenbau erfahrene Fachhandwerker.

Montage en verstelling mogen enkel uitgevoerd worden door een erkend vakman.

Adjustment and regulation only to be done by an experienced tradesman.



Bei allen Verstellungen ist der Türflügel im Schwerpunkt zu entlasten!

Voor alle verstellingen is het noodzakelijk de vleugel te ondersteunen!

Whenever readjusting the door leaf, the load must be taken off the centre of gravity!

Horizontalverstellung · Horizontale verstelling · Horizontal adjustment

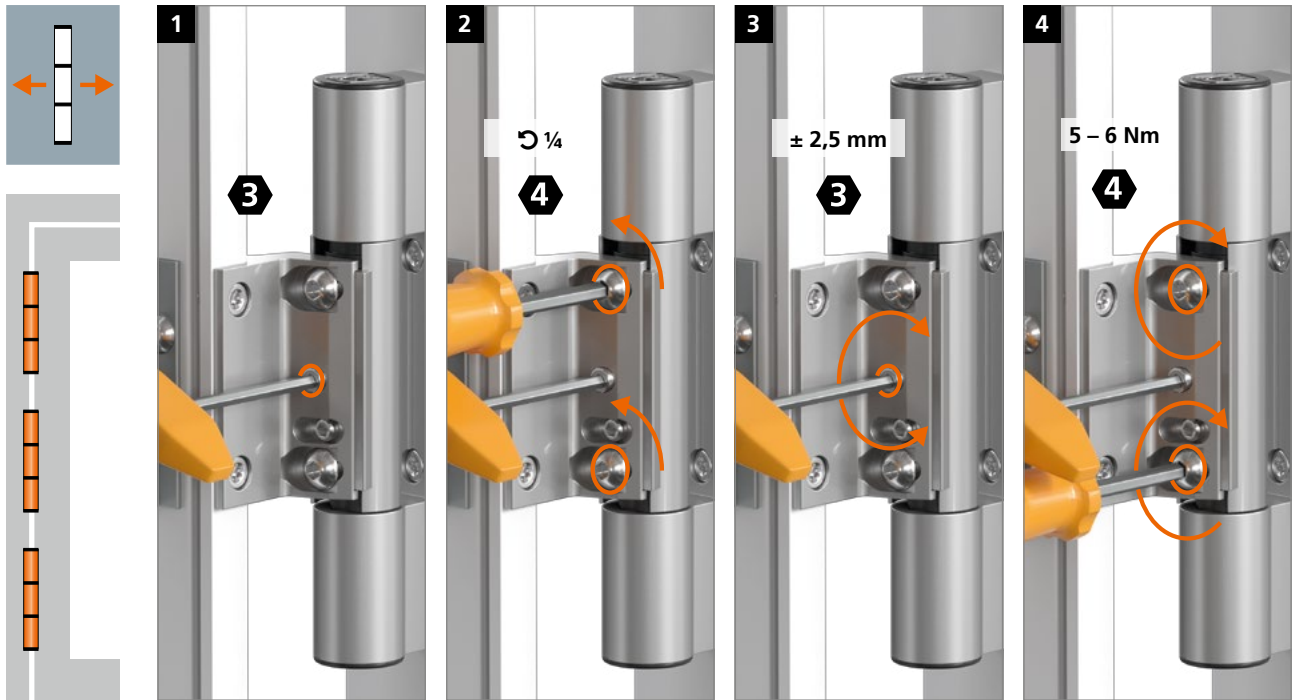

Höhenverstellung · Hoogteverstelling · Adjusting the height

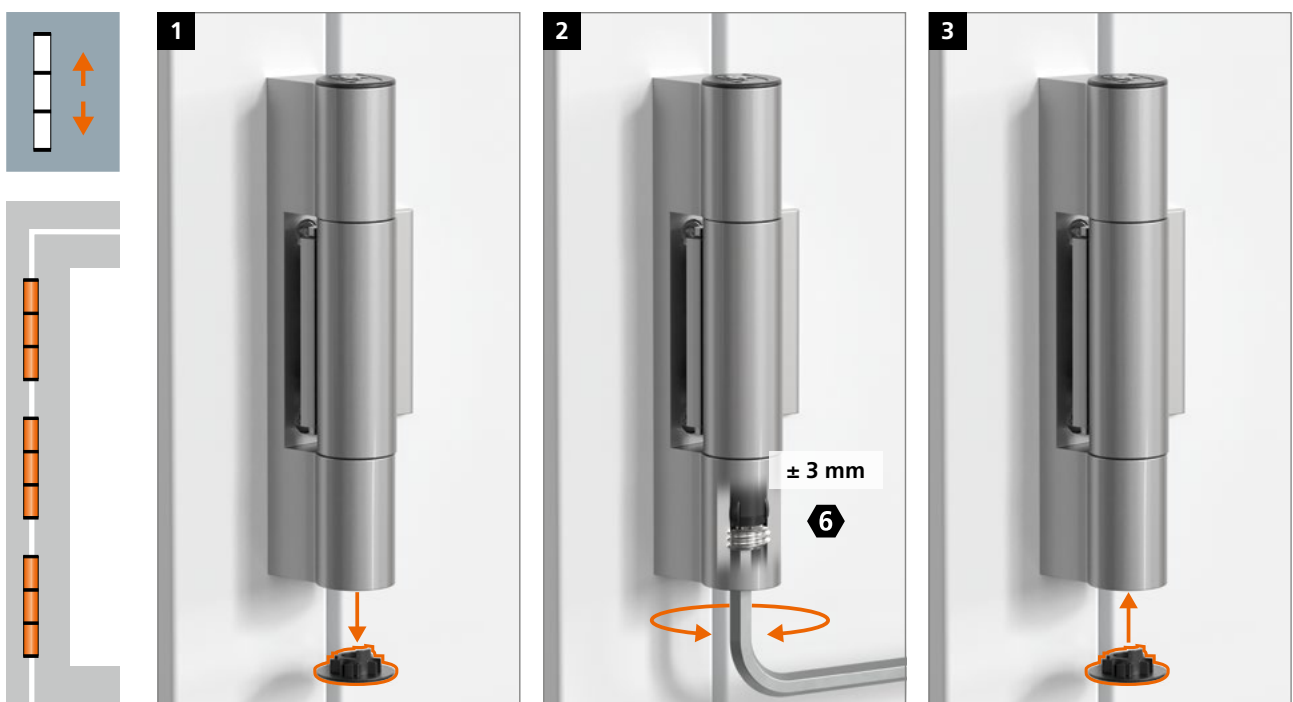

Einstellanleitung
Verstelhandleiding
Adjustment instructions

Verstellung der Bänder nur durch im
 Türenbau erfahrene Fachhandwerker.

Montage en verstelling mogen enkel
 uitgevoerd worden door een erkend vakman.

Adjustment and regulation only to be
 done by an experienced tradesman.

Dichtungsandruckverstellung · Aandrukverstelling · Adjusting the sealing pressure

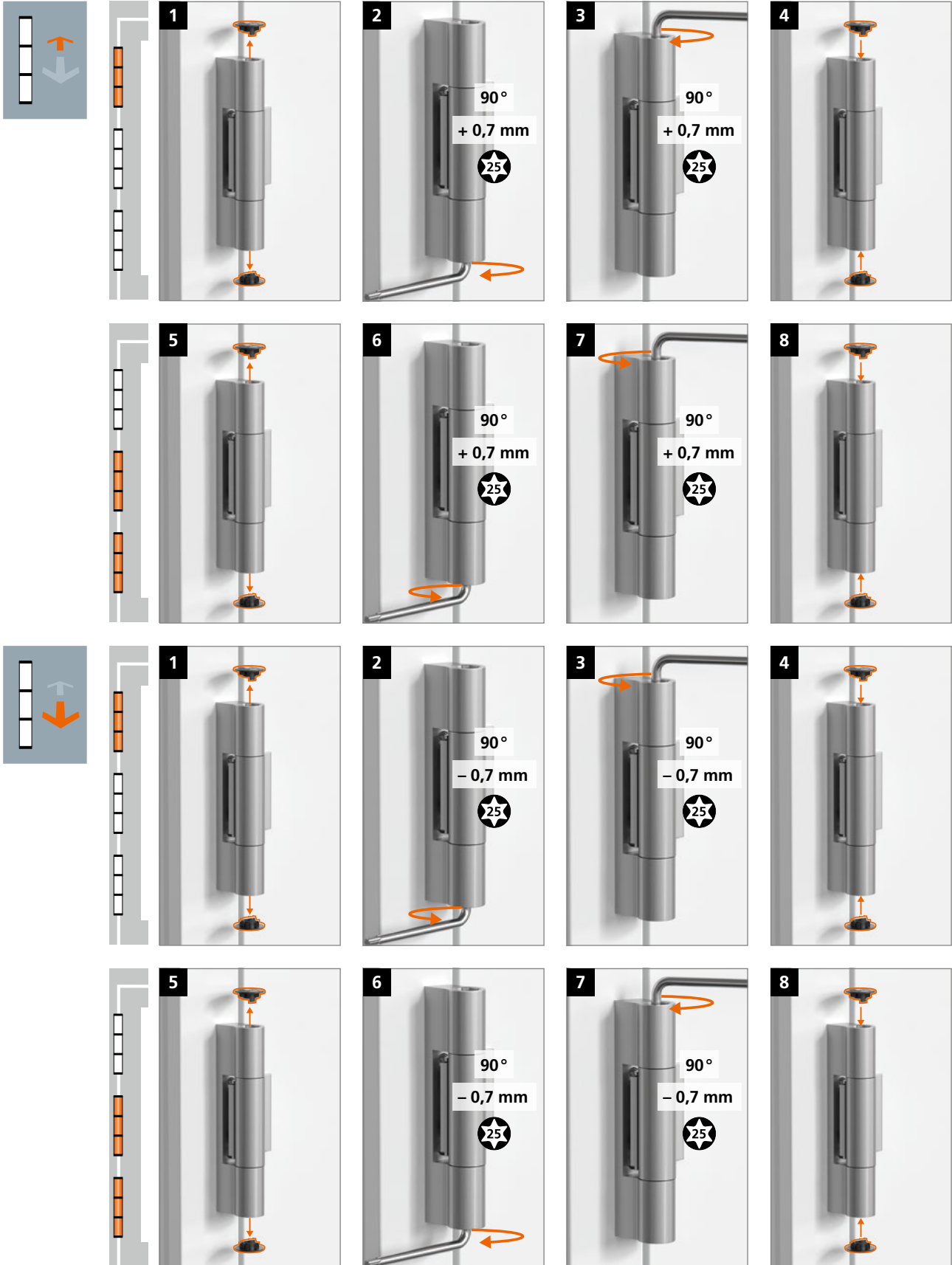

Einstellanleitung
Verstelhandleiding
Adjustment instructions

Verstellung der Bänder nur durch im
Türenbau erfahrene Fachhandwerker.

Montage en verstelling mogen enkel
uitgevoerd worden door een erkend vakman.

Adjustment and regulation only to be
done by an experienced tradesman.

Demontage des Türbands · Demontage van het scharnier · Dissassembly of the hinge

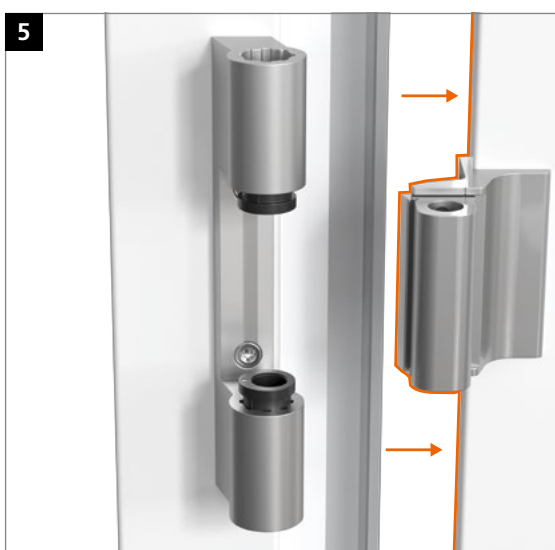
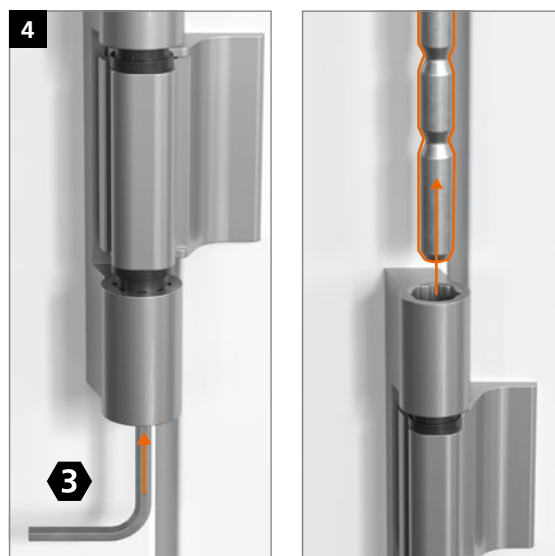
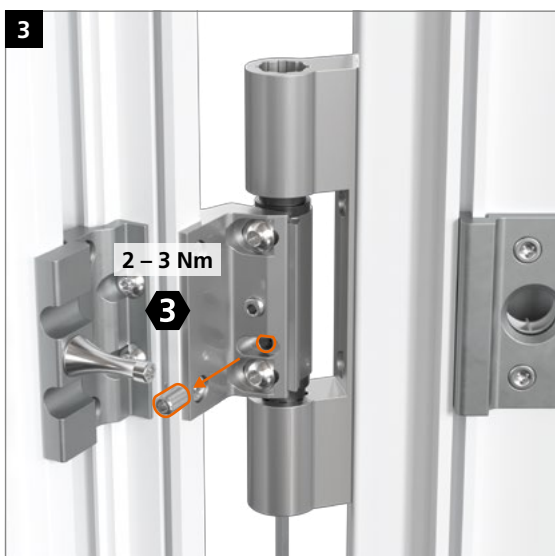
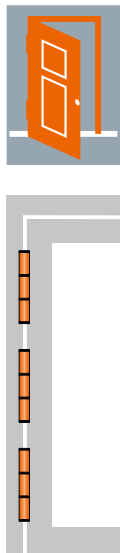

Türband Scharnier · Hinge	Profil · Profiel · Profile				Bohrlehre · Boormal · Drilling jig		
Artikelnummer Artikelnummer Item number	System Systeem System	Serie Serie Series	Rahmen · Kader · Frame	Flügel Vleugel Sash	Rahmen Kader Frame	Sicherungsorn Dievenklauw Securing Pin	Flügel Vleugel Sash
P681_0040	Aluplast	Ideal 7000 NL	170X55	170X35	T300B0289	T300B0287	T300B0296
P681_0050	Deceuninck	Elegant	5135	5116	T300B0291	T300B0297	T300B0292
P681_0052			5143	5116			
			5145 + 5139	5116			
P681_0051		ICOR Thermofibra	5140 + 5138	5116			
			5143	5713			
			5135	5713			
P681_0053	Grando	5145 + 5139	5713	T300B0291	T300B0297	T300B0298	
P681_0054		5140 + 5138	5713	T300B0307	T300B0308		
P681_0011	Gealan	S 9000	6817 + 6818/6843/6844/6804	6027 + 6067 + 6033	T300B0301	T300B0304*	T300B0300
P681_0010			6809 + 6810 + 6811 + 6812	6027 + 6067	T300B0302		
P681_0012			6807/6808/6819/6820	6067	T300B0299		
P681_0000	Profine	76AD	76108 76109	76207	T300B0289	T300B0287	T300B0294
P681_0030	Rehau	Synego NL	1539105 1539055	1537305 1537315	T300B0288	T300B0287	T300B0290
P681_0020	Veka	Softline 82 NL	101333 102331 102335	105381 105381 105381	T300B0289	T300B0306	T300B0295

Zubehör · Toebehoren · Accessories

Rahmen · Kader · Frame



Flügel · Vleugel · Door



Bohrlehre · Boormal · Drilling jig

Sicherungsorn · Dievenklauw · Securing pin



Artikelnummer siehe Tabelle · Artikelnummers zie tabel · Item number please see table



Einbauvorschrift: Geprüfte Einbruchhemmung. Hahn KT-Rollenband NL mit SKG Zertifikat

Montagevorschrift: Geteste inbraakwerendheid. Hahn KT-Rollenband NL met SKG-Certificaat

Min. 3 Bänder

Min. 3 scharnieren

Bei nach außen öffnenden Türen, jedes Band mit Hahn-Sicherungs-Set sichern.*

Bij naar buitendraaiende elementen, elk scharnier met Hahn-veiligheidsset uitrusten.*

Bei flachliegendem Profil wird rahmenseitig eine Armierung von mindestens 1,5 mm Stahl oder 2 mm Aluminium benötigt.

Kaderzijdig minstens 1 wand van 1,5 mm staal- of 2 mm aluminiumversterking vereist bij vlakliggende profielen.

* Nicht notwendig bei nach innen öffnenden Türen.

* Niet nodig bij naar binnen draaiende deuren.

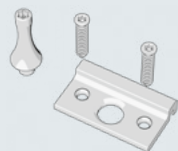

Flügelseitig wird eine Armierung von mindestens 2 mm Stahl oder 2 mm Aluminium benötigt.

Montage van het vleugeldeel door versterking van minimaal 2 mm staal of 2 mm aluminium.

Den Dr. Hahn Türbändern KT-Rollenband NL wurde das SKG/KOMO-Produktzertifikat verliehen. Diese Bänder dürfen damit ohne weitere Prüfung an einbruchhemmenden Kunststofftüren verwendet werden.

Aan de Dr. Hahn deurscharnieren KT-Rollenband NL werd het SKG/KOMO-productcertificaat toegekend. Deze scharnieren kunnen dus zonder verdere testen op iedere kunststofdeur toegepast worden.

Dr. Hahn
TÜR BÄNDER. MADE IN GERMANY.



Dr. Hahn GmbH & Co. KG

Trompeterallee 162-170 · D-41189 Mönchengladbach
Postfach 400109 · D-41181 Mönchengladbach
Phone +49(0)2166/954-3 · E-Mail: sales@dr-hahn.com

www.dr-hahn.eu